



DIRECTIONAL SURFACE MOUNT SL-25 SERIES



TYPE

SPECIFICATIONS

CONSTRUCTION: Cast aluminum or brass directional Bullet; matching stamped aluminum or brass FA-111-SM J-box and adjustable aiming bracket

LENS: High impact clear tempered convex glass

O-RING: High temperature red silicone

LAMP SUPPLIED: 20 watt MR16 FL(BAB) 5000 hours average rating (50w max)

LAMP OPTIONS: We recommend 20 watt MR16 ULTRA 10,000 hours average rating; 20 watt MR16 TITAN 18,000 hours average rating; 4w ARROW LED 50,000 average rating

SOCKET: High temperature ceramic GU5.3 bi-pin with 250°C silicone lead wires

WIRING: Black 3 foot 18/2 zip cord from base of fixture (12v. only)

For 25 foot 16/2 fixture lead wire add **-25F** to catalog number.

MOUNTING: FA-111-SM surface mount J-box

FINISH: Aluminum-Black texture polyester powder coat; optional finishes available. Brass-Unfinished brass; optional finishes available. Stainless Steel - machined finish

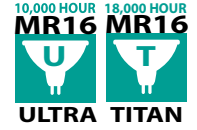

SL-25-BRS

ORDERING INFORMATION

CATALOG NO.	DESCRIPTION	LAMP	SHIP WEIGHT
SL-25-BLT	Cast Aluminum Surface Mount Bullet	20w MR16 FL(BAB)	2.0 lbs.
SL-25-BRS	Cast Brass Surface Mount Bullet	20w MR16 FL(BAB)	3.0 lbs.

LIGHT DISTRIBUTIONS AND PHOTOMETRICS

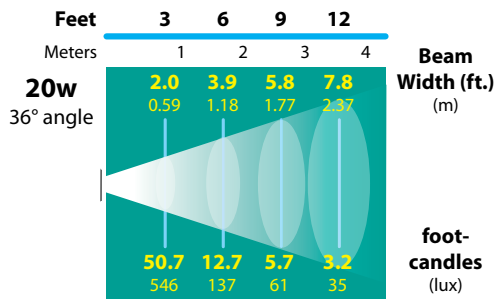

20w MR16 FL(BAB)

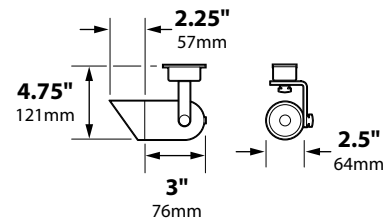

BEAM/GLARE CONTROL ACCESSORIES

CATALOG NO.	DESCRIPTION
FA-08-21	Round 1/8"Hex Cell Louver
FA-11-BLUE	Blue Tempered Glass Lens
FA-11-GREEN	Green Tempered Glass Lens
FA-98	Linear Spread Tempered Glass Lens
FA-104	Wide Spread Tempered Glass Lens Softener

JOB INFORMATION

Type: _____ Date: _____

Job Name: _____

Cat. No.: _____

Lamp(s): _____

Specifier: _____

Contractor: _____

Notes: _____

FOCUS INDUSTRIES INC.
25301 COMMERCENTRE DRIVE
LAKE FOREST, CA 92630

www.focusindustries.com
sales@focusindustries.com
(949) 830-1350 • FAX (949) 830-3390

FSA-00

Powder Coat Finishes	Black Texture	Antique Verde	Bronze Texture	Camel	White Texture	Hunter Texture	Rust	Weathered Iron	Weathered Brown	Stucco	Rubbed Verde	Chrome Powder	Terra Cotta
Ordering Code	-BLT	-ATV	-BRT	-CAM	-WTX	-HTX	-RST	-WIR	-WBR	-STU	-RBV	-CPR	-TRC